

PROCESSING LINE FOR CUTTING THE **HDF** (HIGH-DENSITY FIBREBOARD) BOARDS

v1

2015/09/23

The line is designed for automation of cutting the HDF (high-density fibreboard) boards.

The line consists of the following sections:

- ✓ loading the multi saw – performs the automatic process of feeding the individual boards from the stack to cutting device,
- ✓ multi saw,
- ✓ stacking elements after cutting – fully automated the process of stacking elements after cutting,
- ✓ loading the planing machine – loading the planing device in such a way as to obtain the maximum performance,
- ✓ planing machine.

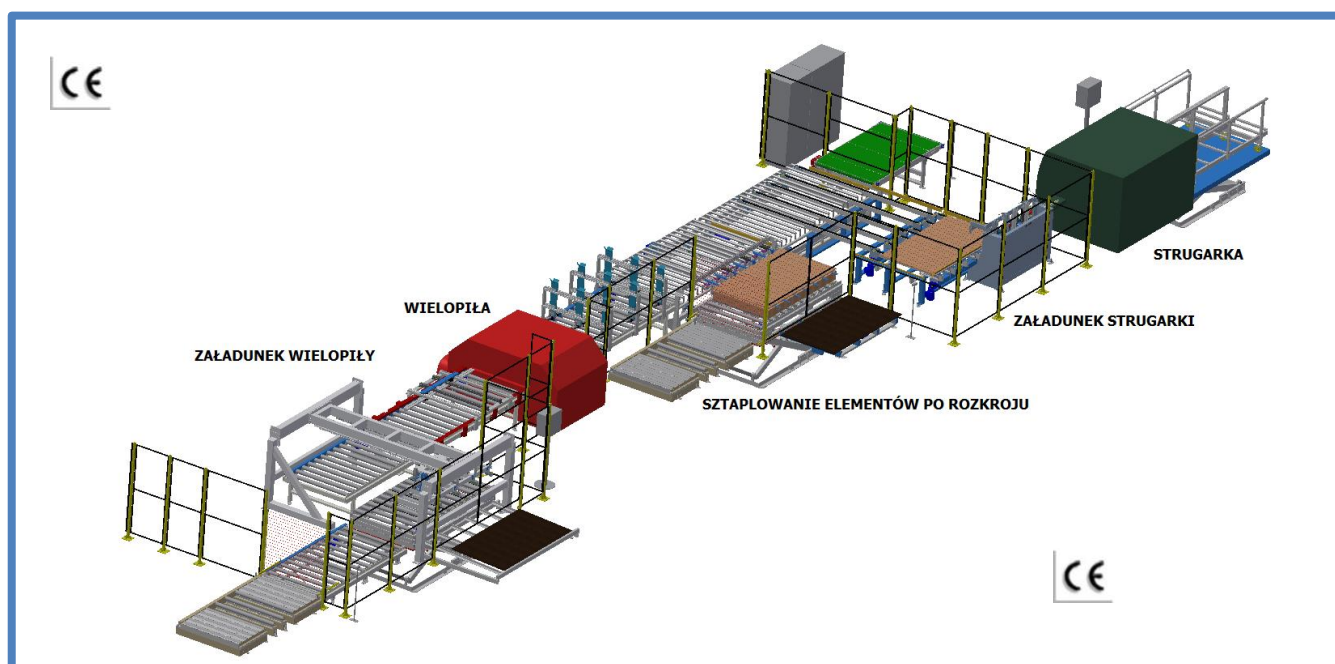

ZAŁADUNEK WIELOPIŁY - loading the multi saw, WIELOPIŁA - multi saw, SZTAPLOWANIE ELEMENTÓW PO ROZKROJU - stacking elements after cutting, ZAŁADUNEK STRUGARKI - loading the planing machine, STRUGARKA - planing machine.

TECHNICAL-OPERATIONAL DATA:

The dimensions of the HDF board:		
- width	mm	800 - 1350
- length	mm	1500 - 2800
- thickness	mm	6 - 50
The speed of transport networks	m/min	18
The performance of planing machine	m/min	max 60